

PART OF THE NORTHWEST QUARTER OF SECTION 13,
TOWNSHIP 18 NORTH, RANGE 17 EAST, W.M.

NOTES:

1. THIS SURVEY WAS PERFORMED USING A TOPCON GTS SERIES TOTAL STATION AND/OR SURVEY GRADE GPS. ACCURACY COMPLIES WITH THE REQUIREMENTS SPECIFIED IN WAC 332-130-080 AND 090.
2. THIS SURVEY MAY NOT SHOW ALL EASEMENTS OR IMPROVEMENTS WHICH MAY PERTAIN TO THIS PROPERTY.
3. FOR SECTIN SUBDIVISION, CORNER DOCUMENTATION, BASIS OF BEARINGS AND ADDITIONAL INFORMATION, SEE BOOK I(i) OF SHORT PLATS, PAGES 235-237.
4. THE PURPOSE OF THIS SURVEY IS TO DELINEATE EASEMENTS ON THE EXISTING INFRASTRUCTURE.

EASEMENT DESCRIPTIONS

EASEMENT Q

EASEMENT Q AS DELINEATED ON THAT CERTAIN SURVEY RECORDED DECEMBER ____, 2018 IN BOOK 41 OF SURVEYS AT PAGES _____, UNDER AUDITOR'S FILE NO. 201812_____, RECORDS OF KITTITAS COUNTY, WASHINGTON; BEING ACROSS A PORTION OF THE NORTHWEST QUARTER OF SECTION 13, TOWNSHIP 18 NORTH, RANGE 17 EAST, W.M., IN THE COUNTY OF KITTITAS, STATE OF WASHINGTON.

EASEMENT R

EASEMENT R AS DELINEATED ON THAT CERTAIN SURVEY RECORDED DECEMBER ____, 2018 IN BOOK 41 OF SURVEYS AT PAGES _____, UNDER AUDITOR'S FILE NO. 201812_____, RECORDS OF KITTITAS COUNTY, WASHINGTON; BEING ACROSS A PORTION OF THE NORTHWEST QUARTER OF SECTION 13, TOWNSHIP 18 NORTH, RANGE 17 EAST, W.M., IN THE COUNTY OF KITTITAS, STATE OF WASHINGTON; AFFECTING A PORTION OF LOT 2 OF THE ROWLEY SHORT PLAT (KITTITAS COUNTY SHORT PLAT NO. SP-06-114), AS PER SHORT PLAT THEREOF RECORDED IN BOOK I(i) OF SHORT PLATS, PAGES 235-237, RECORDS OF KITTITAS COUNTY, WASHINGTON.

EASEMENT S

EASEMENT S AS DELINEATED ON THAT CERTAIN SURVEY RECORDED DECEMBER ____, 2018 IN BOOK 41 OF SURVEYS AT PAGES _____, UNDER AUDITOR'S FILE NO. 201812_____, RECORDS OF KITTITAS COUNTY, WASHINGTON; BEING ACROSS A PORTION OF THE NORTHWEST QUARTER OF SECTION 13, TOWNSHIP 18 NORTH, RANGE 17 EAST, W.M., IN THE COUNTY OF KITTITAS, STATE OF WASHINGTON; AFFECTING A PORTION OF LOT 2 OF THE ROWLEY SHORT PLAT (KITTITAS COUNTY SHORT PLAT NO. SP-06-114), AS PER SHORT PLAT THEREOF RECORDED IN BOOK I(i) OF SHORT PLATS, PAGES 235-237, RECORDS OF KITTITAS COUNTY, WASHINGTON.

EASEMENT T

EASEMENT T AS DELINEATED ON THAT CERTAIN SURVEY RECORDED DECEMBER ____, 2018 IN BOOK 41 OF SURVEYS AT PAGES _____, UNDER AUDITOR'S FILE NO. 201812_____, RECORDS OF KITTITAS COUNTY, WASHINGTON; BEING ACROSS A PORTION OF THE NORTHWEST QUARTER OF SECTION 13, TOWNSHIP 18 NORTH, RANGE 17 EAST, W.M., IN THE COUNTY OF KITTITAS, STATE OF WASHINGTON; AFFECTING A PORTION OF LOT 2 OF THE ROWLEY SHORT PLAT (KITTITAS COUNTY SHORT PLAT NO. SP-06-114), AS PER SHORT PLAT THEREOF RECORDED IN BOOK I(i) OF SHORT PLATS, PAGES 235-237, RECORDS OF KITTITAS COUNTY, WASHINGTON.

EASEMENT S EXPANSION AREA

EASEMENT S EXPANSION AREA AS DELINEATED ON THAT CERTAIN SURVEY RECORDED DECEMBER ____, 2018 IN BOOK 41 OF SURVEYS AT PAGES _____, UNDER AUDITOR'S FILE NO. 201812_____, RECORDS OF KITTITAS COUNTY, WASHINGTON; BEING ACROSS A PORTION OF THE NORTHWEST QUARTER OF SECTION 13, TOWNSHIP 18 NORTH, RANGE 17 EAST, W.M., IN THE COUNTY OF KITTITAS, STATE OF WASHINGTON; AFFECTING A PORTION OF LOT 2 OF THE ROWLEY SHORT PLAT (KITTITAS COUNTY SHORT PLAT NO. SP-06-114), AS PER SHORT PLAT THEREOF RECORDED IN BOOK I(i) OF SHORT PLATS, PAGES 235-237, RECORDS OF KITTITAS COUNTY, WASHINGTON.

EASEMENT T EXPANSION AREA

EASEMENT T EXPANSION AREA AS DELINEATED ON THAT CERTAIN SURVEY RECORDED DECEMBER ____, 2018 IN BOOK 41 OF SURVEYS AT PAGES _____, UNDER AUDITOR'S FILE NO. 201812_____, RECORDS OF KITTITAS COUNTY, WASHINGTON; BEING ACROSS A PORTION OF THE NORTHWEST QUARTER OF SECTION 13, TOWNSHIP 18 NORTH, RANGE 17 EAST, W.M., IN THE COUNTY OF KITTITAS, STATE OF WASHINGTON; AFFECTING A PORTION OF LOT 2 OF THE ROWLEY SHORT PLAT (KITTITAS COUNTY SHORT PLAT NO. SP-06-114), AS PER SHORT PLAT THEREOF RECORDED IN BOOK I(i) OF SHORT PLATS, PAGES 235-237, RECORDS OF KITTITAS COUNTY, WASHINGTON.

RECEIVED
MAR 22 2019
Kittitas County CDS

AUDITOR'S CERTIFICATE

Filed for record this _____ day of _____
2018, at _____ M., in Book 41 of Surveys at
_____ (s) _____ at the request of Cruse & Associates.

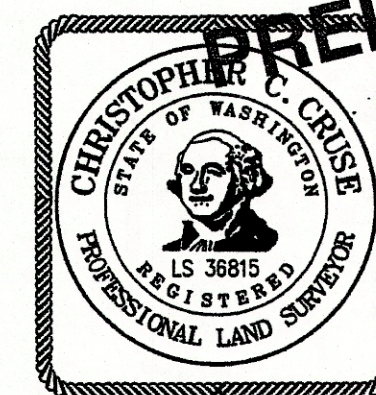

JERALD V. PETTIT BY:
KITTITAS COUNTY AUDITOR

CRUSE & ASSOCIATES
PROFESSIONAL LAND SURVEYORS
217 East Fourth Street P.O. Box 959
Ellensburg, WA 98926 (509) 962-8242

THORP FRUIT & ANTIQUE MALL, L.L.C.